

Authorization for Medication Administration in School

Student Name: _____ DOB: _____ Grade: _____

TO BE COMPLETED BY PRESCRIBING PHYSICIAN

Medication: Prescription Over the Counter

Name of Medication _____ Dosage _____ Route _____ Time(s) to Be Taken _____

Diagnosis or reason for medication: _____

If given PRN, specify the minimum length of time between doses: _____

Possible medication side effects: _____

Restrictions or Special Instructions: _____

I request and authorize the above-named student be administered the above medication in accordance with the instructions indicated above from _____ to _____ (not to exceed current school year). (date) (date)

_____ Date

_____ Physician Name (please print)

_____ Telephone Number

_____ Physician's Signature

OFFICE STAMP:



TO BE COMPLETED BY THE PARENT / GUARDIAN

- I give my permission for this medication to be administered to my child at school. The school has my permission to call the physician with any questions regarding the medication.
I understand and acknowledge that any medication administered to my child during school will more than likely not be administered by a registered nurse or other medical professional. In consideration of the school administering medication to my child pursuant to this authorization, I hereby release and hold harmless the school, the Archdiocese of St. Louis, and their employees, agents or representative, from any liability that may arise from administering medication to my child.
All medication supplied must be brought to school in its original container with instructions as noted above by the physician.

_____ Date

_____ Parent/Guardian Name (Print)

_____ Parent/Guardian Signature

Please ask the pharmacist for an extra-labeled bottle for school. Thank you!

Asthma Action Plan



General Information:

Name _____
 Emergency contact _____ Phone numbers _____
 Physician/healthcare provider _____ Phone numbers _____
 Physician signature _____ Date _____

Severity Classification	Triggers	Exercise
<input type="checkbox"/> Intermittent <input type="checkbox"/> Moderate Persistent <input type="checkbox"/> Mild Persistent <input type="checkbox"/> Severe Persistent	<input type="checkbox"/> Colds <input type="checkbox"/> Smoke <input type="checkbox"/> Weather <input type="checkbox"/> Exercise <input type="checkbox"/> Dust <input type="checkbox"/> Air Pollution <input type="checkbox"/> Animals <input type="checkbox"/> Food <input type="checkbox"/> Other _____	1. Premedication (how much and when) _____ 2. Exercise modifications _____

Green Zone: Doing Well

Symptoms

- Breathing is good
- No cough or wheeze
- Can work and play
- Sleeps well at night

Peak Flow Meter

More than 80% of personal best or _____

Peak Flow Meter Personal Best = _____

Control Medications:

Medicine	How Much to Take	When to Take It

Yellow Zone: Getting Worse

Symptoms

- Some problems breathing
- Cough, wheeze, or chest tight
- Problems working or playing
- Wake at night

Peak Flow Meter

Between 50% and 80% of personal best or _____ to _____

Contact physician if using quick relief more than 2 times per week.

Continue control medicines and add:

Medicine	How Much to Take	When to Take It

IF your symptoms (and peak flow, if used) return to Green Zone after one hour of the quick-relief treatment, THEN

- Take quick-relief medication every 4 hours for 1 to 2 days.
- Change your long-term control medicine by _____
- Contact your physician for follow-up care.

IF your symptoms (and peak flow, if used) DO NOT return to Green Zone after one hour of the quick-relief treatment, THEN

- Take quick-relief treatment again.
- Change your long-term control medicine by _____
- Call your physician/Healthcare provider within _____ hour(s) of modifying your medication routine.

Red Zone: Medical Alert

Symptoms

- Lots of problems breathing
- Cannot work or play
- Getting worse instead of better
- Medicine is not helping

Peak Flow Meter

Less than 50% of personal best or _____ to _____

Ambulance/Emergency Phone Number:

Continue control medicines and add:

Medicine	How Much to Take	When to Take It

Go to the hospital or call for an ambulance if:

- Still in the red zone after 15 minutes.
- You have not been able to reach your physician/healthcare provider for help.
- _____

Call an ambulance immediately if the following danger signs are present:

- Trouble walking/talking due to shortness of breath.
- Lips or fingernails are blue.



FARE
Food Allergy Research & Education

FOOD ALLERGY & ANAPHYLAXIS EMERGENCY CARE PLAN

Name: _____ D.O.B.: _____

Allergy to: _____

Weight: _____ lbs. Asthma: Yes (higher risk for a severe reaction) No

NOTE: Do not depend on antihistamines or inhalers (bronchodilators) to treat a severe reaction. USE EPINEPHRINE.

Extremely reactive to the following allergens: _____

THEREFORE:

- If checked, give epinephrine immediately if the allergen was **LIKELY** eaten, for **ANY** symptoms.
- If checked, give epinephrine immediately if the allergen was **DEFINITELY** eaten, even if no symptoms are apparent.

FOR ANY OF THE FOLLOWING:
SEVERE SYMPTOMS



LUNG

Shortness of breath, wheezing, repetitive cough



HEART

Pale or bluish skin, faintness, weak pulse, dizziness



THROAT

Tight or hoarse throat, trouble breathing or swallowing



MOUTH

Significant swelling of the tongue or lips



SKIN

Many hives over body, widespread redness



GUT

Repetitive vomiting, severe diarrhea



OTHER

Feeling something bad is about to happen, anxiety, confusion

OR A COMBINATION of symptoms from different body areas.

1. **INJECT EPINEPHRINE IMMEDIATELY.**
2. **Call 911.** Tell emergency dispatcher the person is having anaphylaxis and may need epinephrine when emergency responders arrive.
 - Consider giving additional medications following epinephrine:
 - » Antihistamine
 - » Inhaler (bronchodilator) if wheezing
 - Lay the person flat, raise legs and keep warm. If breathing is difficult or they are vomiting, let them sit up or lie on their side.
 - If symptoms do not improve, or symptoms return, more doses of epinephrine can be given about 5 minutes or more after the last dose.
 - Alert emergency contacts.
 - Transport patient to ER, even if symptoms resolve. Patient should remain in ER for at least 4 hours because symptoms may return.

MILD SYMPTOMS



NOSE

Itchy or runny nose, sneezing



MOUTH

Itchy mouth



SKIN

A few hives, mild itch



GUT

Mild nausea or discomfort

FOR MILD SYMPTOMS FROM MORE THAN ONE SYSTEM AREA, GIVE EPINEPHRINE.

FOR MILD SYMPTOMS FROM A SINGLE SYSTEM AREA, FOLLOW THE DIRECTIONS BELOW:

1. Antihistamines may be given, if ordered by a healthcare provider.
2. Stay with the person; alert emergency contacts.
3. Watch closely for changes. If symptoms worsen, give epinephrine.

MEDICATIONS/DOSES

Epinephrine Brand or Generic: _____

Epinephrine Dose: 0.1 mg IM 0.15 mg IM 0.3 mg IM

Antihistamine Brand or Generic: _____

Antihistamine Dose: _____

Other (e.g., inhaler-bronchodilator if wheezing): _____



FARE
Food Allergy Research & Education

FOOD ALLERGY & ANAPHYLAXIS EMERGENCY CARE PLAN

HOW TO USE AUVI-Q® (EPINEPRHINE INJECTION, USP), KALEO

1. Remove Auvi-Q from the outer case.
2. Pull off red safety guard.
3. Place black end of Auvi-Q against the middle of the outer thigh.
4. Press firmly until you hear a click and hiss sound, and hold in place for 2 seconds.
5. Call 911 and get emergency medical help right away.

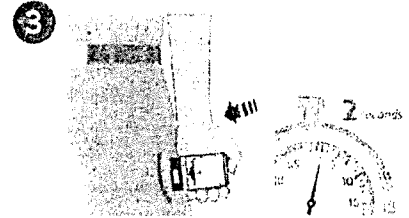

HOW TO USE EPIPEN® AND EPIPEN JR® (EPINEPHRINE) AUTO-INJECTOR AND EPINEPHRINE INJECTION (AUTHORIZED GENERIC OF EPIPEN®), USP AUTO-INJECTOR, MYLAN AUTO-INJECTOR, MYLAN

1. Remove the EpiPen® or EpiPen Jr® Auto-Injector from the clear carrier tube.
2. Grasp the auto-injector in your fist with the orange tip (needle end) pointing downward.
3. With your other hand, remove the blue safety release by pulling straight up.
4. Swing and push the auto-injector firmly into the middle of the outer thigh until it 'clicks'.
5. Hold firmly in place for 3 seconds (count slowly 1, 2, 3).
6. Remove and massage the injection area for 10 seconds.
7. Call 911 and get emergency medical help right away.

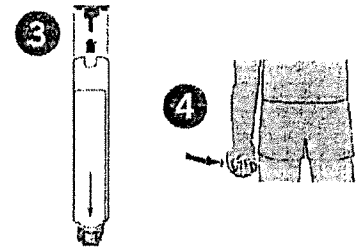

HOW TO USE IMPAX EPINEPHRINE INJECTION (AUTHORIZED GENERIC OF ADRENALICK®), USP AUTO-INJECTOR, IMPAX LABORATORIES

1. Remove epinephrine auto-injector from its protective carrying case.
2. Pull off both blue end caps: you will now see a red tip.
3. Grasp the auto-injector in your fist with the red tip pointing downward.
4. Put the red tip against the middle of the outer thigh at a 90-degree angle, perpendicular to the thigh.
5. Press down hard and hold firmly against the thigh for approximately 10 seconds.
6. Remove and massage the area for 10 seconds.
7. Call 911 and get emergency medical help right away.

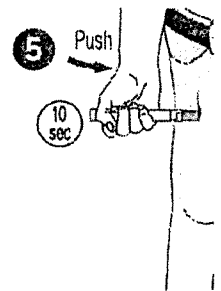

ADMINISTRATION AND SAFETY INFORMATION FOR ALL AUTO-INJECTORS:

1. Do not put your thumb, fingers or hand over the tip of the auto-injector or inject into any body part other than mid-outer thigh. In case of accidental injection, go immediately to the nearest emergency room.
2. If administering to a young child, hold their leg firmly in place before and during injection to prevent injuries.
3. Epinephrine can be injected through clothing if needed.
4. Call 911 immediately after injection.

OTHER DIRECTIONS/INFORMATION (may self-carry epinephrine, may self-administer epinephrine, etc.):

Treat the person before calling emergency contacts. The first signs of a reaction can be mild, but symptoms can worsen quickly.

EMERGENCY CONTACTS — CALL 911

RESCUE SQUAD: _____
 DOCTOR: _____ PHONE: _____
 PARENT/GUARDIAN: _____ PHONE: _____

OTHER EMERGENCY CONTACTS

NAME/RELATIONSHIP: _____
 PHONE: _____
 NAME/RELATIONSHIP: _____
 PHONE: _____